

1. Seitenansicht.

2. Vorderansicht.

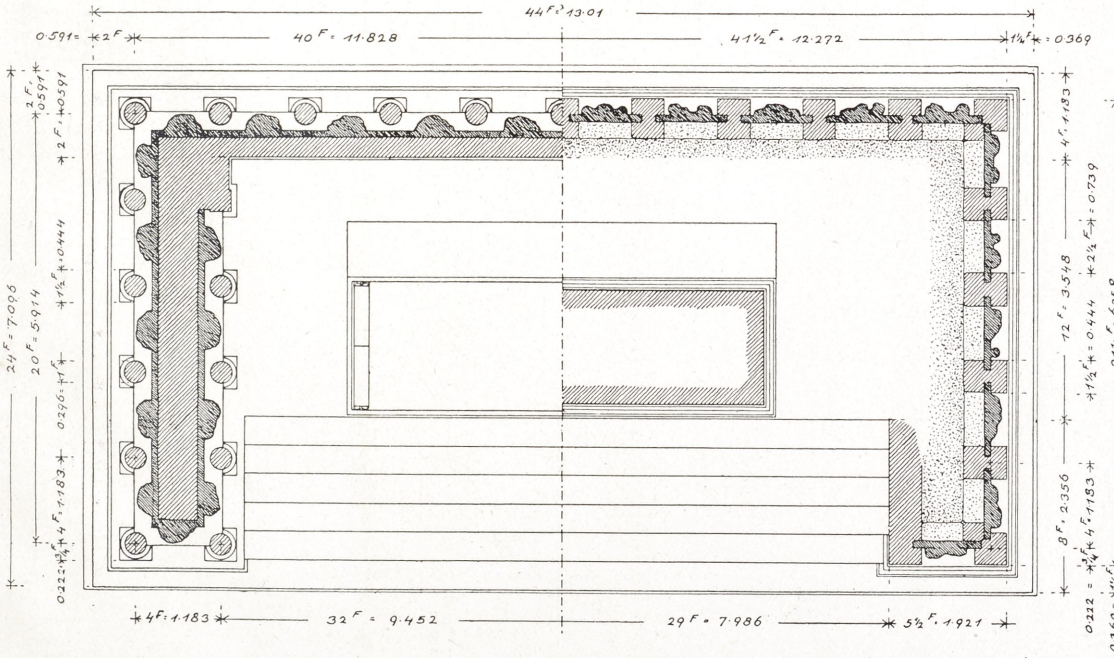
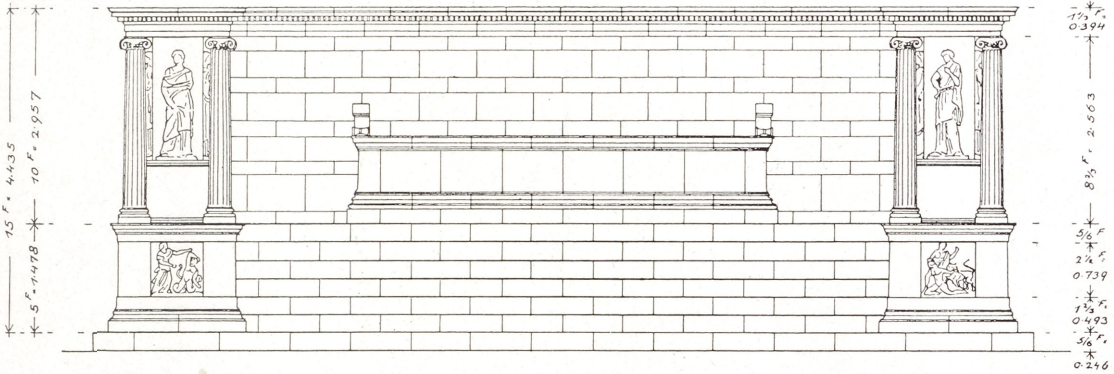
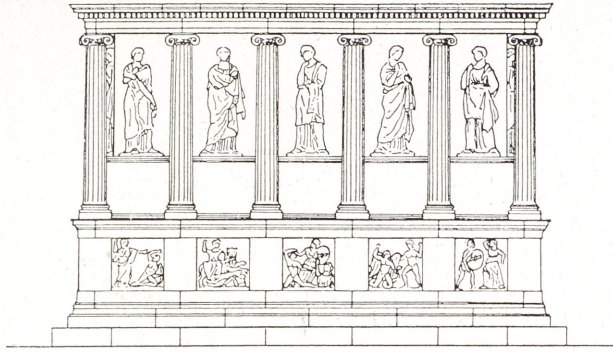

3. Grundriss.

Der Altar des Athenatempels von Priene.

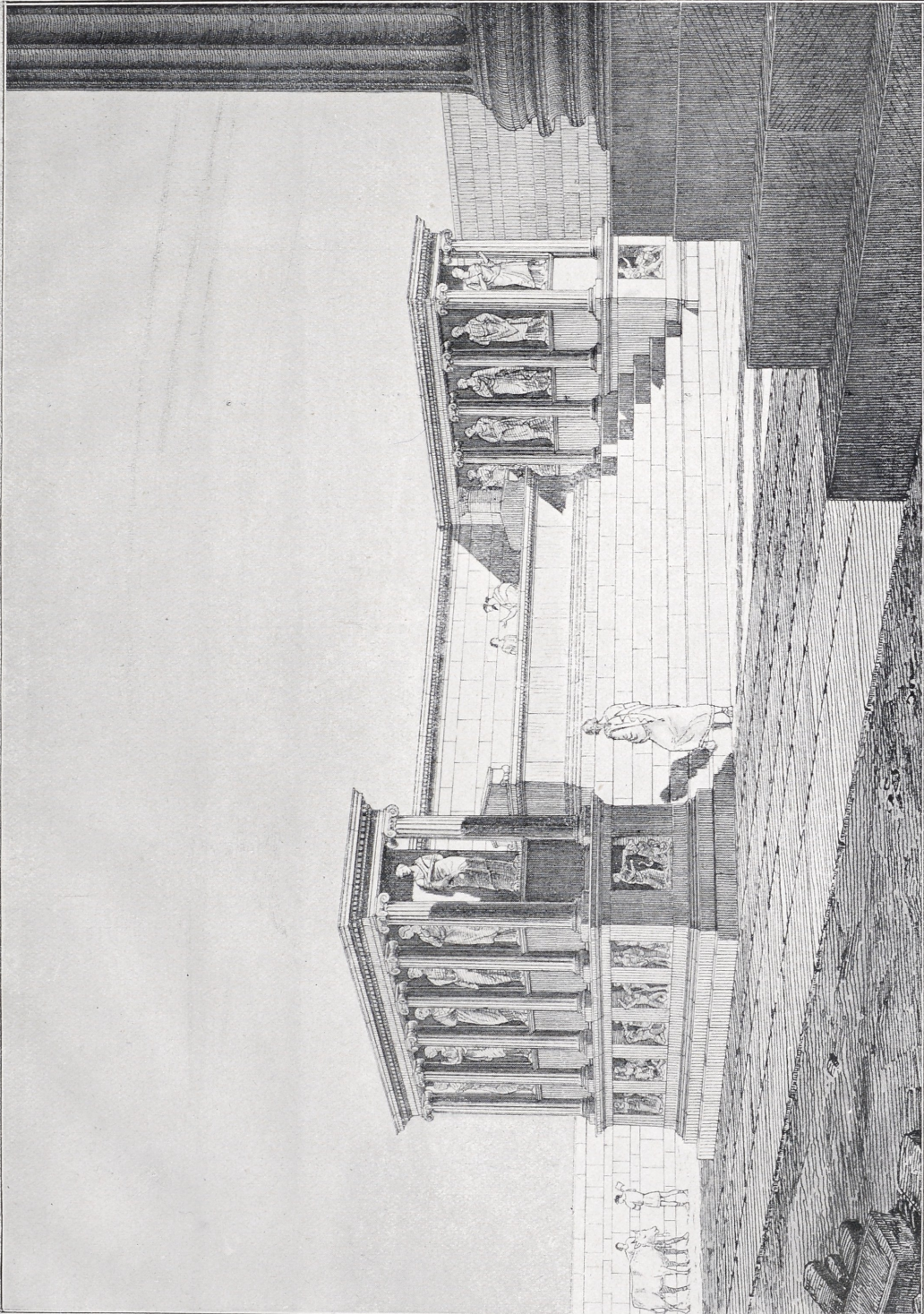

Der Altar des Athenatempels von Priene.

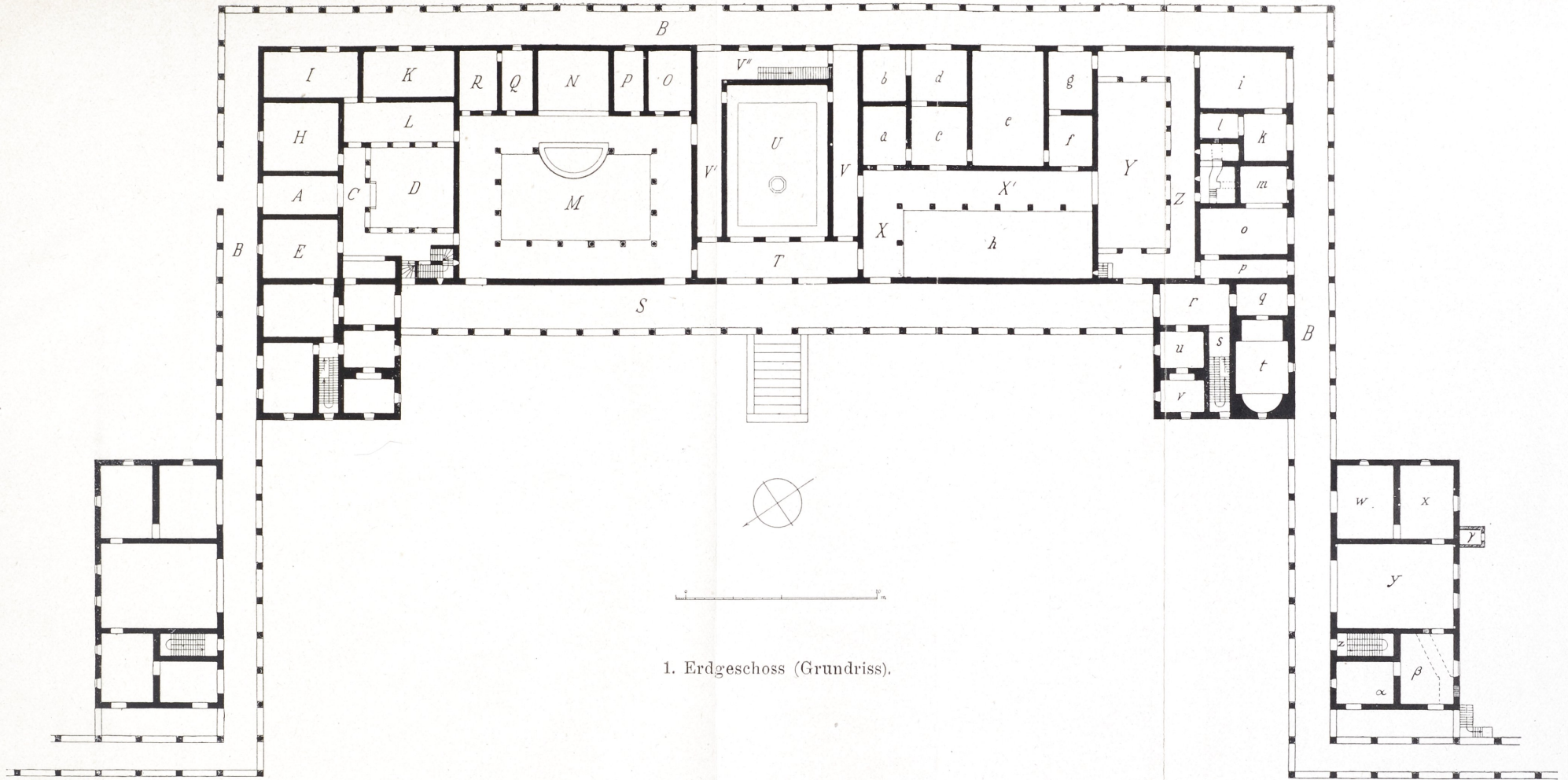

Mylius 1920

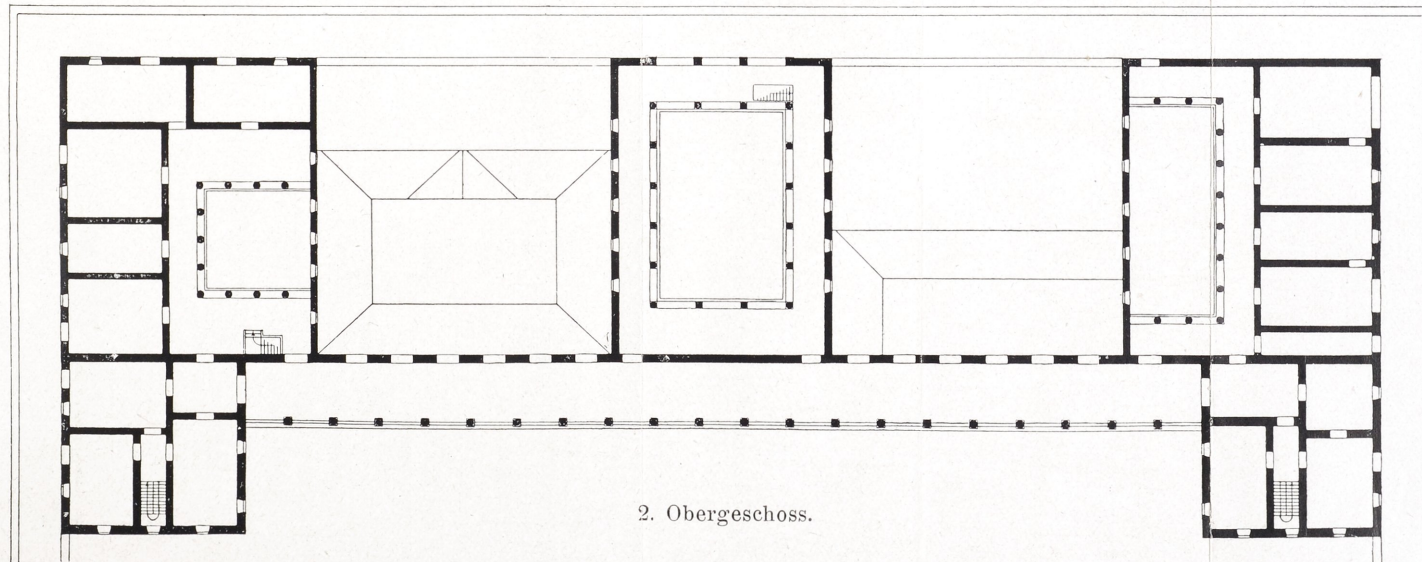

Die römische Villa bei Nennig.

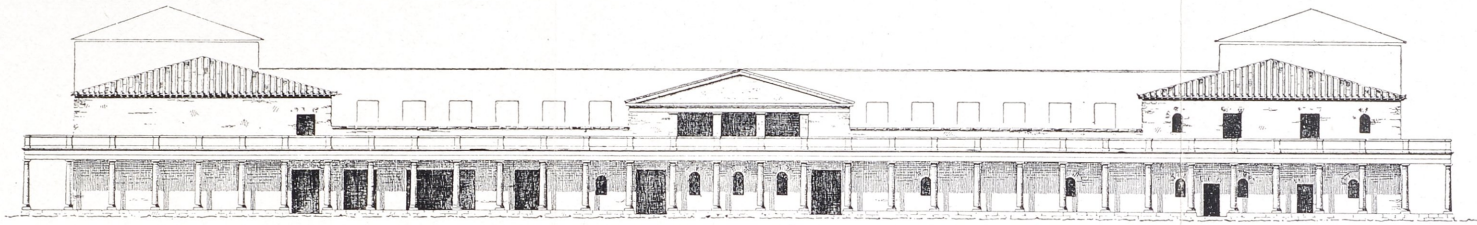

1. Rückseite.

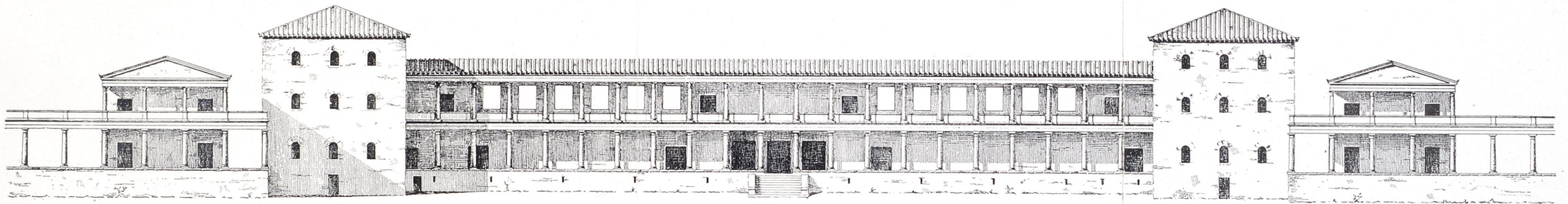

2. Vorderseite.

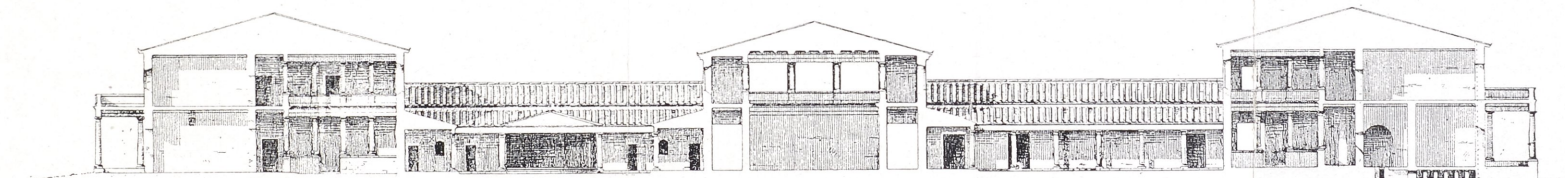

3. Längsschnitt.

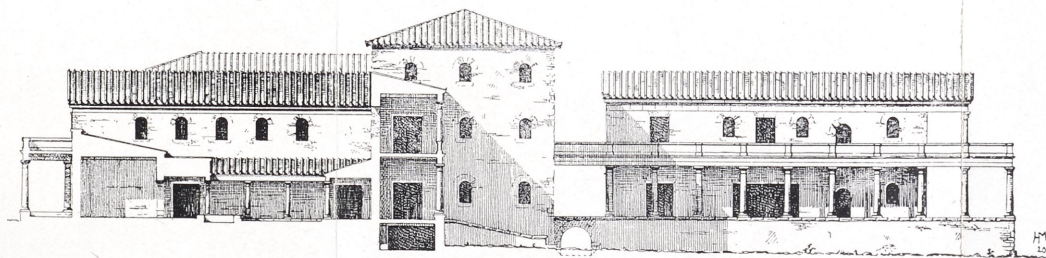

4. Querschnitt.

Die römische Villa bei Nennig.

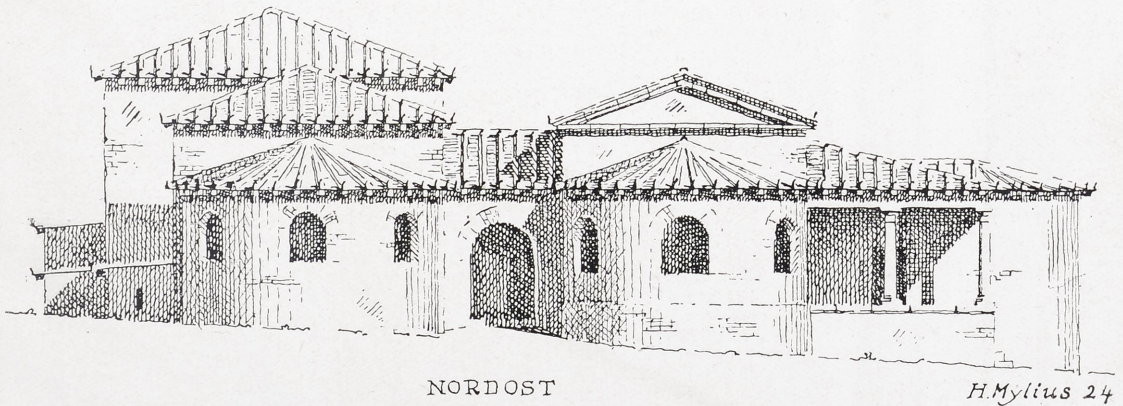
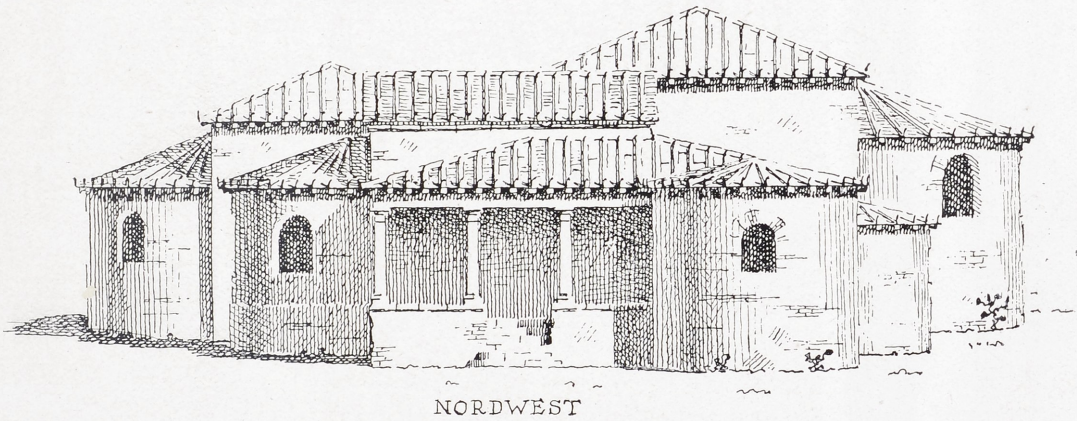
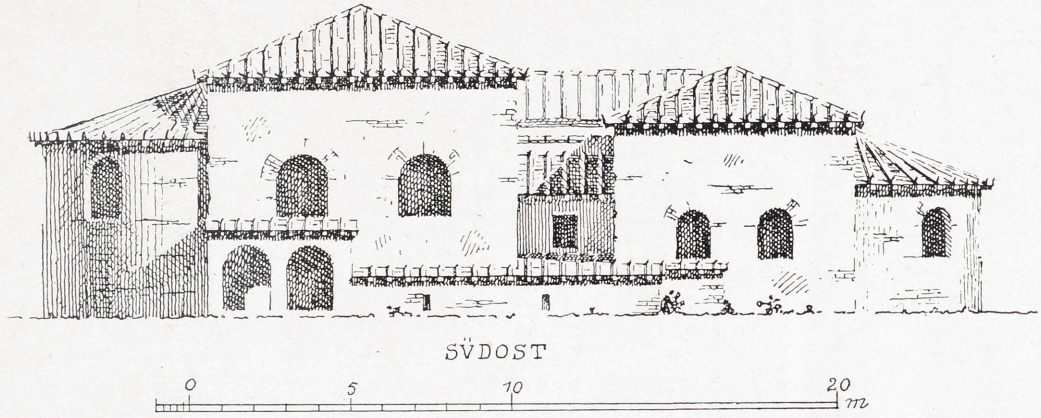

Bad der römischen Villa bei Nennig.

H. Mylius 24

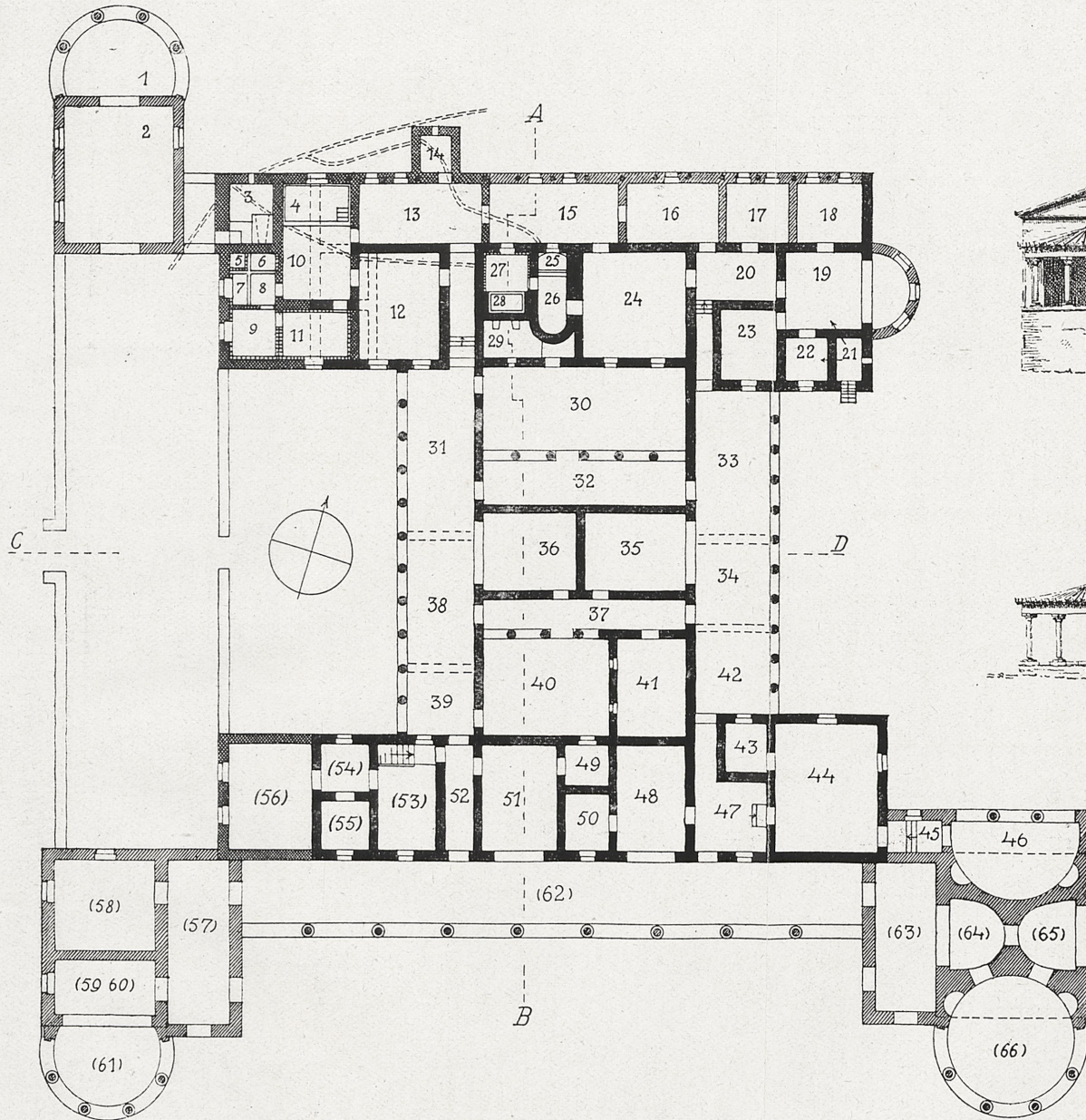

■ I. BAUPERIODE.
 ■ II. " "
 ■ III. " "

0 5 10 20 30 40 m

1. Grundriss.

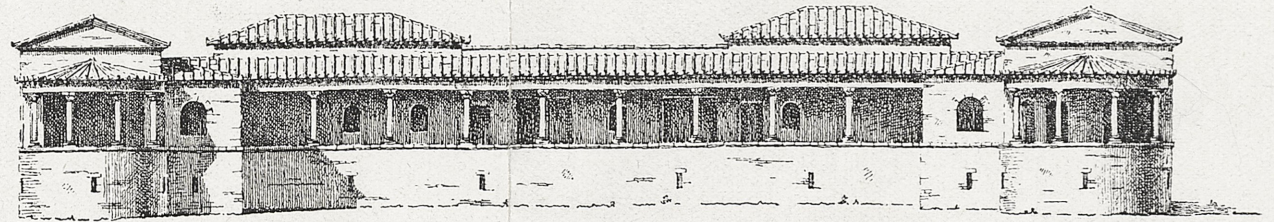

VON SÜDEN

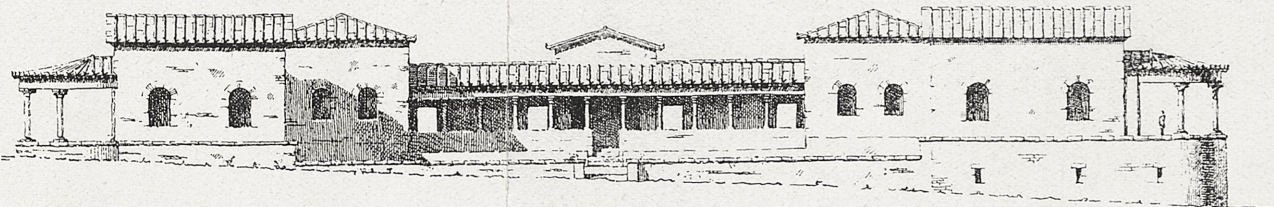

VON WESTEN

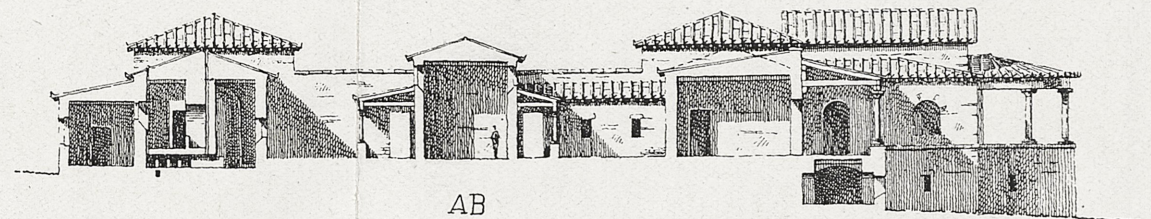

AB

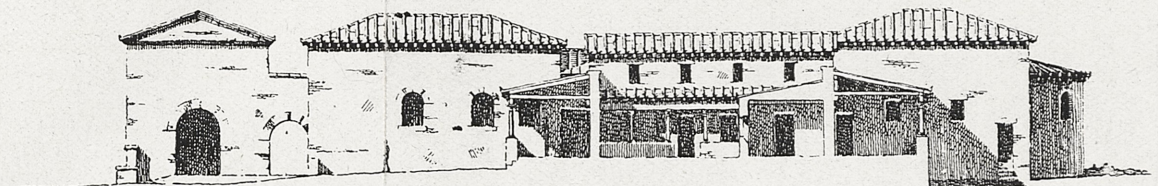

CD

2. Ansichten und Schnitte.

Hyllus 1924.

Die römische Villa bei Fliessem.

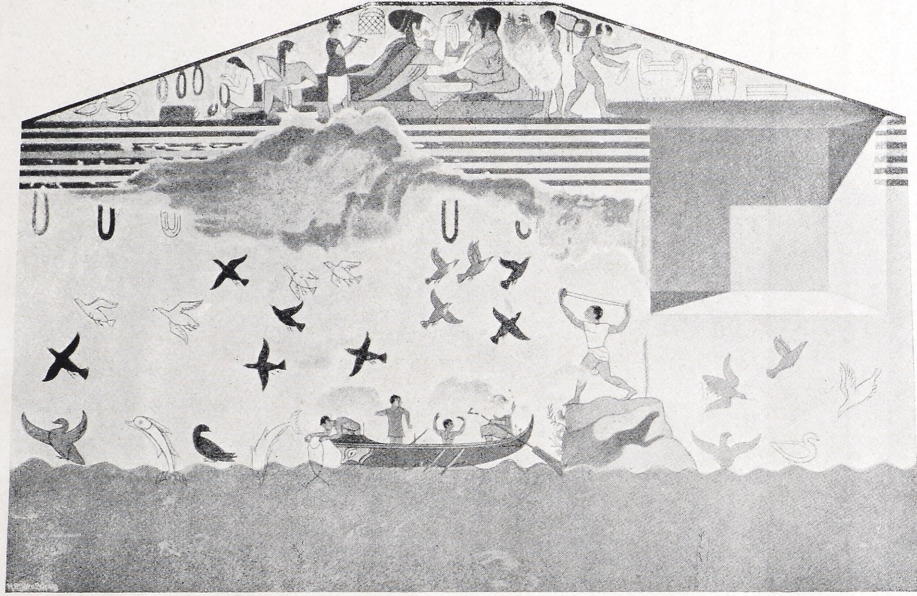

1. Wandgemälde aus Tomba della caccia.



2. Argonautenkrater von Orvieto.
(Springer-Michaelis¹² S. 259, Fig. 491.)



1. Amazonenkrater (A. J. XXXIII. 1918 S. 4 Abb. 2a).



2. Talosvase (Springer-Michaelis¹² S. 314 Abb. 583).

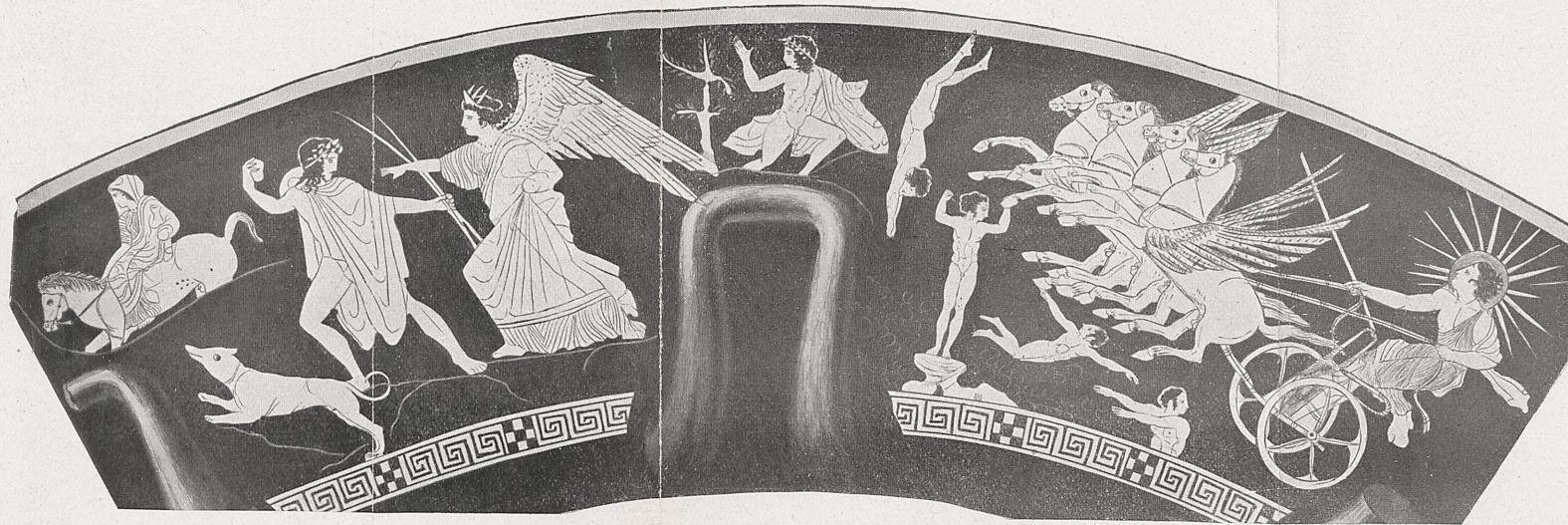

3. Sonnenaufgangsvase (nach Furtwängler-Reichhold).



4. Die Ficonische Cista (nach aquarellierter Zeichnung von F. Winter).

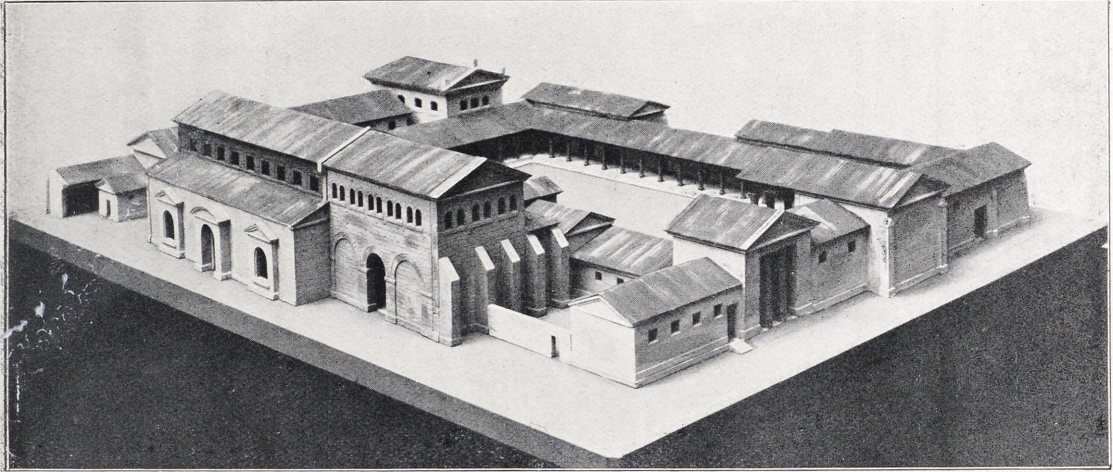

1. Blick von Norden.

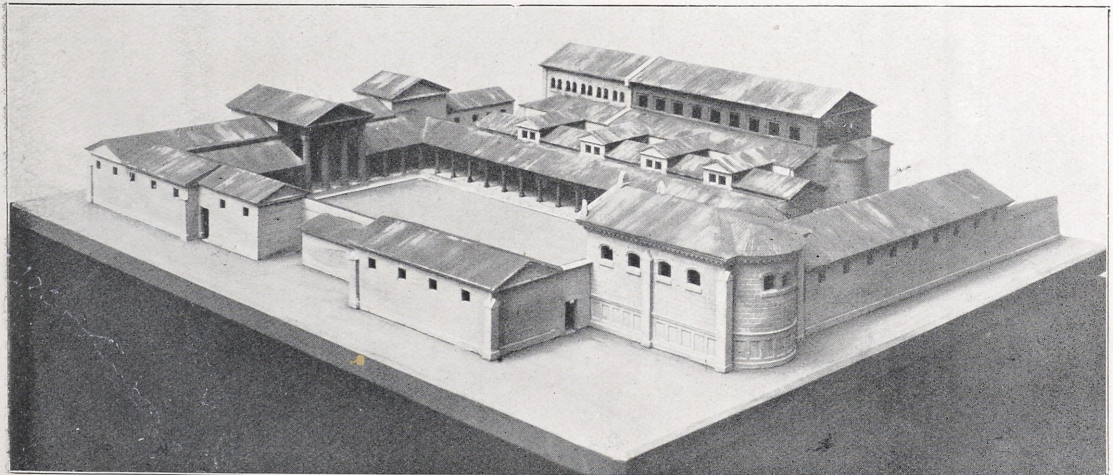

2. Blick von Süden.

Modell des Forums von Kempten.